

45FW | 45J | 45K

COMPREHENSIVE FEATURES

- Liberty Bridge® Integrated Freightliner® Custom Chassis SL
- Freightliner® BrakeSync standard
- 20k lb. Front Axle with 365 Tires
- Cummins Diesel Engine (605HP, 1950 ft. lb)
- 12.5kW Onan QD Generator with AGS
- Select Drive™ Premium Steering System
- Dual Coat Painted Steel Platform Construction
- Added Exterior Light Strips to Rear Engine Grille & Behind Rear Upper Spoiler
- Dual Dash Monitors to One Large 20" Single Monitor
- Cockpit Area
Enhanced Ghost Audio w/Transducers
- Added Stainless Steel to Surface of Power Entry Step
- Forward Fuel Tank - 150 gal
- Water Pump - Upgrade 5.3GPM REBEL
- Sani Con Turbo 600S Waste Management System
- Driver Window (Fresco with Power Side Slide Toll Window) **NEW FOR MY27**
- Power Cord Reel - Added Wireless Remote **NEW FOR MY27**
- Power Water Hose Reel - Added Wireless Remote **NEW FOR MY27**
- Electrical & Battery Compartment Redesign
Improved functionality by fully enclosing batteries, creating storage area in bay
Lithium GC3 Batteries (3) 270Ah each OPTION
- Service Station/Wet Bay Redesign
Improved functionality and streamlined look with control panel on luggage door for easy access & powered knife valves
- Enhanced Living Room and Bedroom Sound Capabilities by Upgrading to Klipsch Soundbars.
- Luggage Doors
Powered push button locks for extra convenience & added lock/unlock button on exterior grab bar
- Power Basement Slide Trays (2) Increased Size by 25% Per Tray
(2 Power Trays Now STANDARD)
- Stow N Go Storage Compartments (4.8ft3)
- Freezer/Cooler
Rotated Orientation, to Extend Past Slideout Box
- Fisher & Paykel 240V 3400W Cooktop with Added 50 amp Sub Panel
- Exterior Entertainment TV Box
Upgraded soundbar to Klipsch soundbar
- APEX® Custom Residential Furniture Designs
- Quartz Countertops by Cambria Throughout
- FCCC® RoadWatch state-of-the-art driving and safety system includes automatic traction control, electronic stability control with roll stability support, adaptive cruise control, and collision mitigation with forward warning and active braking.
- UltraSteer Tag Axle reduces turning by 17' compared to a fixed tag axle or 8' tighter than the competitions passive steer tag axle.
- Platinum Experience Warranty includes -2yr / 24k mile coach, 5yr / 50k structural, 3 years REV assist roadside assistance, dedicated customer service team and now includes the PX owners mobile app.
- HWH Pump and manifold relocated for improved performance, enhanced weight distribution, and increased storage.



45FW



45J

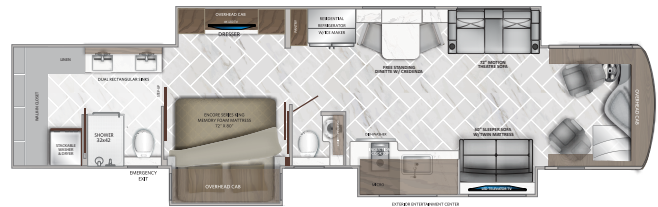

45K



AVAILABLE OPTIONS

- Exterior Freezer
- 43" Front Overhead LED TV
- Standard Cabinet w/o Dishwasher
- Theater Seating with Sleeper Sofa (45K)
- Dual Recliners (45FW & 45K)
- Booth Dinette (45FW, 45J, 45K)
- Rear Ladder
- Starlink Satellite System
- Interior Hardware - Matte Black, Chrome and Brushed Bronze
- Additional Exterior Graphics
- Blackout Package
- Banquette (45FW & 45J)
- Sofa Sleeper w/Queen Mattress (45FW)
- Sofa Sleeper w/Full Mattress (45FW)
- Free-Standing Dinette w/Credenza (45FW)
- Lithium Battery Package
- Technology Package:
Cell Booster, 330W Solar Panel
(Note: Wifi Ranger™ Denali-LTE w/Router is Standard)

APPALOOSA DÉCOR

- NEW FOR MY27



ISLAMORADA DÉCOR

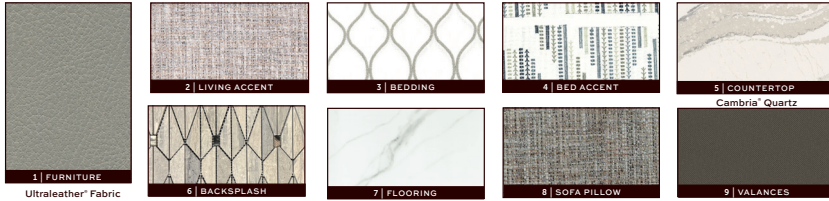

KEY LARGO DÉCOR

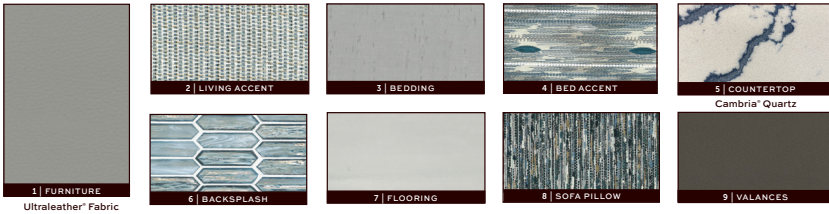

MAYBROOKE DÉCOR

- AVAILABLE ON THE 45FW ONLY

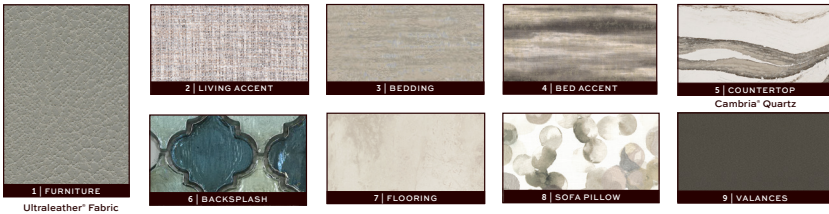

HARDWOOD CABINETRY

TRADITIONAL DOOR PROFILE



AMERICAN BLACK WALNUT



CHELSEA



HAZELNUT

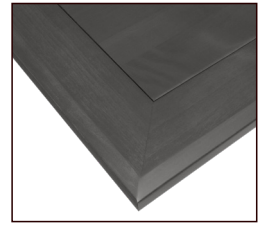

IMPERIAL

MODERN DOOR PROFILE

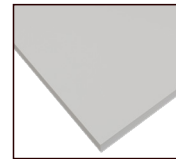

MINDFUL GREY
HIGH-GLOSS
CABINETRY

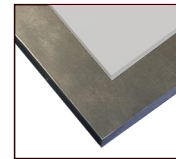

2-TONE CABINETRY
IMPERIAL HIGH-GLOSS
MINDFUL GREY HIGH-GLOSS



2-TONE CABINETRY
AMERICAN BLACK WALNUT
CHARCOAL
NEW WOOD COLOR

CHASSIS

MODEL	45FW	45J	45K
Wheelbase	317"	317"	317"
Front GAWR (lbs)	20,000	20,000	20,000
Rear GAWR (lbs)	20,000	20,000	20,000
Tag GAWR (lbs)	14,000	14,000	14,000
GCWR (lbs)	74,000	74,000	74,000
Hitch Rating Weight (lbs)	20,000	20,000	20,000
Tongue Weight (lbs)	2,000	2,000	2,000
Fuel Capacity (gal)	150	150	150

LIBERTY BRIDGE® CHASSIS

Model: Freightliner Custom Chassis® SL
 Engine: Cummins® X15
 Horsepower: 605HP Engine with 3 Stage Engine Brake
 Torque: 1950 lb/ft
 Hitch Rating: 20,000 lb
 Transmission: Allison 4000 Series Transmission, 6-Speed



DIMENSIONS & CAPACITIES

MODEL	45FW	45J	45K
Overall Length	44' 11"	44' 11"	44' 11"
Overall Height	13' 1"	13' 1"	13' 1"
Overall Width*	102"	102"	102"
Interior Height*	84"	84"	84"
Interior Width*	96"	96"	96"
Patio Awning Width	19' 8"	19' 8"	19' 8"
2nd Awning Width	16'	16'	16'
Interior Storage (cu. ft.)	200	180	200
Exterior Storage (cu. ft.)	150	150	150
Fresh Water Capacity (gal)	105	105	105
Grey Water Capacity (gal)	70	70	70
Black Water Capacity (gal)	50	50	50

*Overall Width, interior height and width measured with slide-box in.

EXTERIORS



CAPITAL

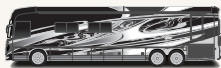

COVERT

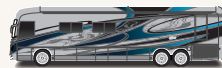

FORTITUDE

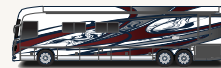

FREEDOM



FRONTIER



GATEWAY



INDEPENDENCE

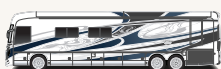

NEWPORT

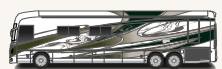

REPUBLIC



RESOLUTE



REVOLT

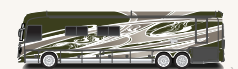

TERREBONNE