

T H E 1 9 9 9
A M E R I C A N H E R I T A G E

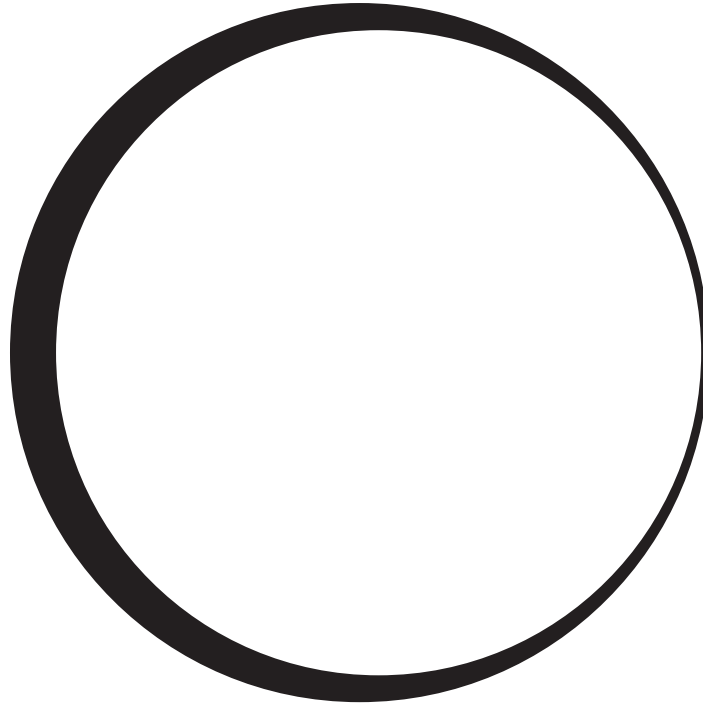

F R E E D O M H A S C O M E F U L L C I R C L E .



We'll assume, from your interest in American Coach products, that you've owned a few motorcoaches before. Maybe even yachts, race cars, or airplanes. But in all your travels, we suspect you've never gripped the wheel of anything quite like this. The 1999 American Heritage. Forty-five feet of boundless luxury, imagination, and power all rolled into one truly exhilarating vehicle. Climb aboard. Cast your inhibitions to the wind. And never slow down again. Life, after all, was meant to be lived at full throttle.

T H E 1 9 9 9 A M E R I C A N H E R I T A G E



American Coach

THE ROAD BECKONS. AMERICA CALLS.

Fleetwood Motorhomes of Indiana, Inc. • Plant #44 • 1031 U.S. 224 East • Decatur, Indiana 46733-5006 • (219) 728-2121 (800) 648-6582

PLEASE READ: Product information and photography in this brochure were as accurate as possible at the time of publication. Subsequent refinements may be evident in the actual product. Prices and specifications are subject to change without notice. Selected decorator items shown in the photographs are not part of the product unless specified. All liquid capacities, dimensions, and weights are nominal. Warranty valid only on product sold in the U.S.A. and Canada.

FLEETWOOD RV

WANT TO SEE 12 ENGINEERS CRY LIKE A BABY? RELEASE 45 FEET OF SPORTY STYLING ONTO THE OPEN ROAD.

Okay, so our engineers were a little emotional when the first American Heritage rolled onto the highway. You'd be choked up, too, if you'd spent the last three years of your life trying to make an impossible dream come true.

But today, the proof is before you. Presenting the 1999 American Heritage — the first vehicle ever to combine the sporty styling of a touring bus with the comforting price range of a high line motorcoach.

It all started three years ago with a clean sheet of paper, a room full of American Coach owners, and several pots of coffee. We asked current owners what they'd like to see in a new top-of-the-line motorcoach.

What should it look like? What's the right length? Do you

want to spend more time in the kitchen or less? What luxury features do you prefer? How can we improve the cockpit? And so on.

Our goal was to create a whole new kind of luxury vehicle from the ground up.

Mission accomplished. The 1999 American Heritage is everything you asked for, and then some. It looks like an expensive touring bus, for instance, but it carries a price tag that's nowhere near high-end bus country.

And, while it's built on a custom-designed Spartan® chassis like every American Coach product, the American Heritage is a good five feet longer. So there's extra room for all sorts of delightful surprises. Like over 43,000 pounds of carrying capacity. Twin pass-through



Overall Length 45' 0"

Overall Height w/AC 12' 1"

Overall Width (Max.) 101-1/2"

Interior Height (Max.) 81"

Interior Width (Max.) 96"

New from the ground up, the American Heritage is a stunning example of what can happen when talented minds are allowed to roam freely. The 45-foot coach was researched, designed, and built entirely in Decatur, Indiana, by a special project team.

These twin, pass-through slide-out trays will swallow up just about anything you feed in — ten-speed bikes, golf clubs, inner tubes, and so forth. Each eight-foot tray holds up to 1,000 pounds of cargo and conveniently slides through to the opposite side of the coach.



As convenience would have it, all water hookups are located in the same brightly lit compartment. For quick cleanups, there's also a wash-down station with hot and cold water, a spray nozzle, a soap dispenser, and a paper towel holder.



Imagine the world as seen through this immense, bus-style windshield. It's 50" tall and 100" wide for all-out visibility. At night, a powered windshield curtain provides added privacy. And on frosty mornings, the Aqua Hot™ hydronic furnace graciously defrosts the windshield while you're still asleep.



To protect the paint on your beautiful bus front, you can choose this optional Lexan® bus armor. The clear acrylic shield does the same job as the standard vinyl bra cover, but with a little more panache.



With tires as big as these Goodyear® 11R/22.5" steel belted radials, the American Heritage rides a little higher off the ground. That's why it's equipped with a two-tier power entry step, like most buses.



Exquisitely designed, the American Heritage features smooth fiberglass sidewalls, chrome and stainless steel accents, and your choice of 12 different color schemes. Also note the liberal use of awnings. You'll find them above the patio, bedroom windows, front door, and slide-out.

Welcome to one of the best engineered doorways we've ever seen. Ours comes with a thoughtful awning, a deluxe entry handle and porch light, a no-rattle screen door, and a unique front entry door with three separate locking mechanisms: keyless, deadbolt, and air locks. For added safety, the door has extra large windows that allow you to see small cars and pedestrians down below.

compartment slide-out trays. An extra awning just for the front door. A sprawling bath area with his and her sinks. And even an available outdoor entertainment center featuring a 27" Sony® color television.

Almost brings tears to your eyes, doesn't it? The 1999 American Heritage. Come see the coach that's changing the look of the open road.



Hoping to watch a little World Cup soccer action while your copilot's at the wheel? Switch on the available Datron® In-Motion Digital Satellite System. It transmits crisp, clear satellite pictures to the TV even though you're buzzing down the highway at 70 mph. It's the same technology found on jet airliners.



Notre Dame's playing? There's no need to scurry indoors when you have this optional 27" Sony® color television outside. It's mounted on a slide-out swivel tray so you can easily block out sun glare. Other options include a Sony® AM/FM radio and cassette player, two stereo speakers, and a phone jack.



While you're appreciating the beauty of the American Heritage, don't overlook the less obvious (but no less important) features. Like a Sony® rear vision camera with audio hookup. An audible reverse warning system. A heavy-duty trailer hitch with 10,000 lb. capacity. A lighted chrome and rubber rock guard. An Onan® 10 kw Quiet Diesel generator. The list goes on and on.

THE 1999 AMERICAN HERITAGE

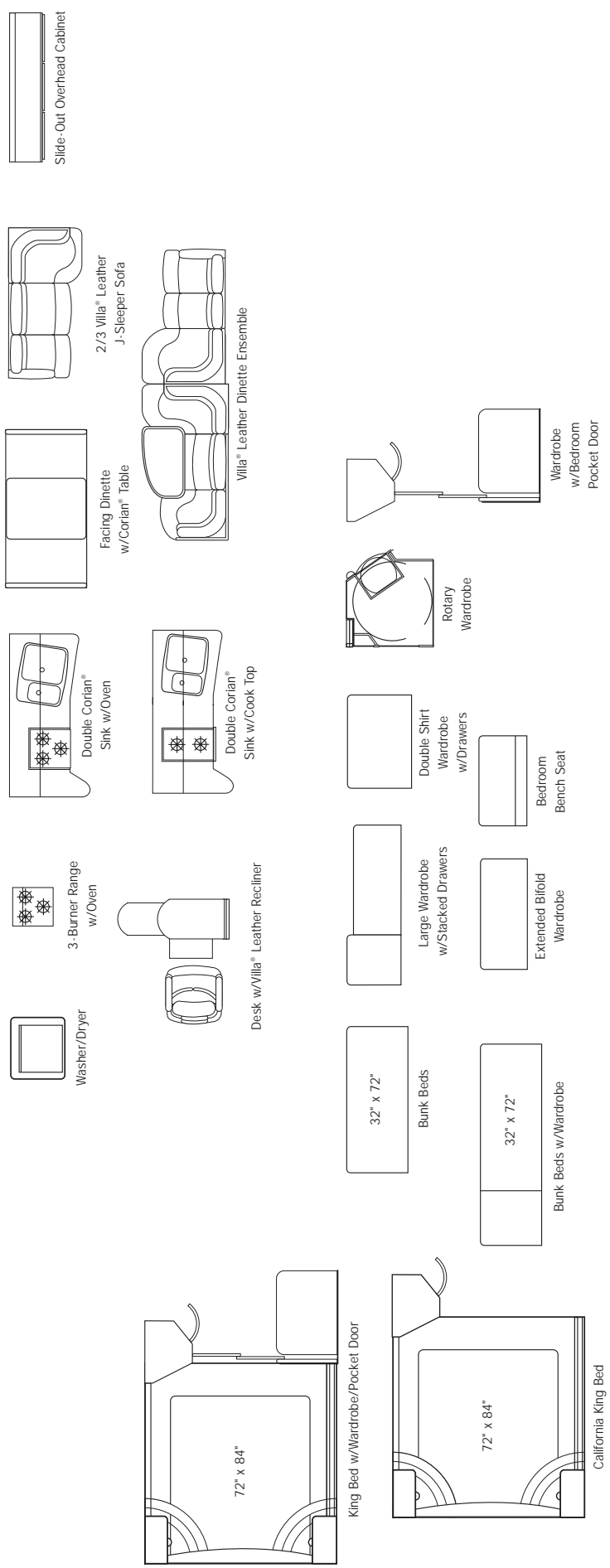
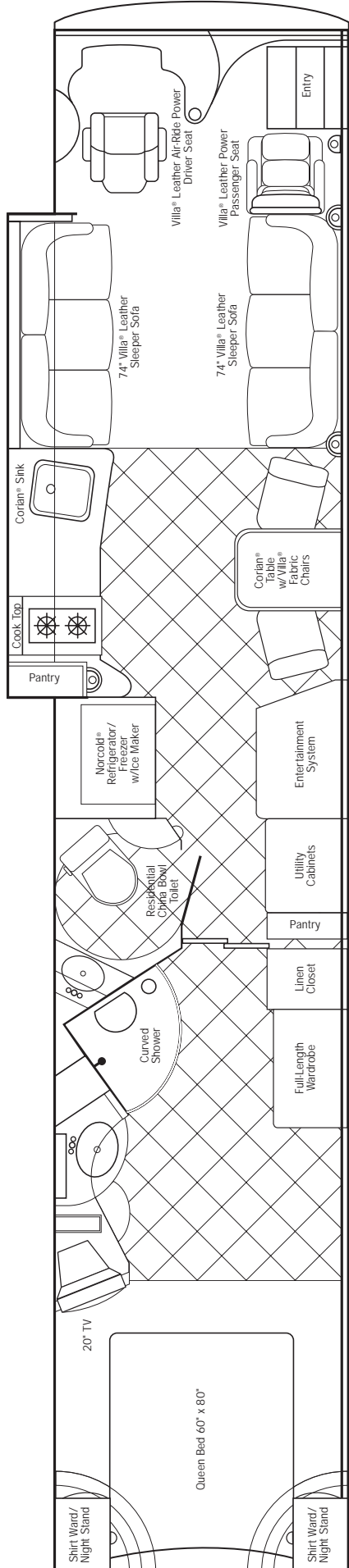

Standard Features

10.8 M11 Cummins® Engine, 450 HP Turbo Diesel
Spartan® Chassis
Allison® HD 4060 World Trans Six-Speed Electronic Transmission
Full Air Suspension w/Bilstein® Shocks
Anti-Lock Air Brake System w/Automatic Traction Control (ATC)
Full Air Brakes w/Automatic Slack Adjusters
Independent Front Suspension
Stacked Rail Chassis Frame
Steerable Tag Axle
Cruise Control
3-Point Semi-Automatic Leveling Jacks
MC 1000 Trip Computer
Fully Adjustable VDO Pneumatic Dash
Full Instrumentation/Analog/Electronic — VDO
Back Lighted Instrument Panel
45° Steering Angle
Leather Wrapped Steering Wheel
Single Motor Windshield Wiper System
Intermittent Wipers
Double Swivel Visors
Cab Side Pull-Down Shade
Powered Windshield Privacy Curtain
Auxiliary 12V Dash Receptacle
I.C.C. Light Switch
Driver & Passenger Climate Controls — A/C & Heat
Driver & Passenger Map Lights
Villa® Leather 6-Way Air-Operated Power Driver Seat
Villa® Leather 6-Way Power Passenger Seat w/Electric Footrest
Sony® Rear Vision System w/Audio
Audible Reverse Warning System
Sony® Stereo AM/FM/Cassette Player (Cockpit)
Sony® Stereo 10-Pack Compact Disc Player (Cockpit)

Molded Cab Panels
Driver Power Window
Automotive Style Heated Rearview Mirrors w/Remote Adjustment
Chrome "Bus-Like" Rearview Mirrors
Non-Mobile Window Defrost
Dual Chrome Air Horns — Roof Mounted
Pneumatic Pop-Up Stepwell Cover
Entry Step Switch at Entry Wall
Undercoating
Fire Extinguisher
Steel Surface on Front Bulkhead/Engine Frame
Automatic Generator Start System
(2) 12V Chassis Batteries — 2000 CCA
(6) 6V House Batteries — Deep Cycle 270 Amp
Battery Shut-Off Switches, Coach & Chassis
Polyethylene Battery Trays
Electronic Battery Control Center
Trailer Hitch — 10,000 Lb. Capacity
Sound Insulation in Subfloors, Front & Rear
Jacobs "C" Brake
Underhood Utility Light — Front & Rear
Aluminum Wheels (6), Steel Wheels (2)
Goodyear® 11R/22.5" Steel Belted Radial Tires
Lighted Rear Chrome/Rubber Rock Guard
Mud Flaps

Structural

Vacubond Floor
Vacubond Walls w/Smooth Fiberglass Exterior Skin
Steel Reinforced Sidewall & Ceiling Construction
Steel Outriggers on Chassis
Heated Water & Holding Tank Compartments
Vacubond Insulated & Padded Storage Areas
Bonded Windshield w/Steel Frame

12 Exterior Graphics Colors
Domed Fiberglass Roof w/Radius Corners
Full Fiberglass Caps (Front & Rear)
Smooth, One-Piece Hand Laid Fiberglass Sidewalls
Fiberglass Front Quarter Panels
Polished Stainless Steel Bumpers (Front & Rear)
Bus-Style 50" Large Windshield
Automotive Headlights
PIAA Dual Spotlight w/Remote Control
PIAA Driving Lights
PIAA Docking Lights (Front & Rear)
Auxiliary Fog Lamps
Power Double Entry Step
31" Wide Entry Door w/Keyless Lock, Deadbolt Lock & Pneumatic (Air) Locks
Deluxe Screen Door
Deluxe Entry Handle w/Logo
Dual Porch Light
Dual Glazed Tinted Windows w/Screens
Lighted Front Insignia
Front Entry Awning
DS/RS Awning Rail Molding
21' Patio Awning w/2 Matching Embroidered Lawn Chairs
6' Doorside (DS) & Roadside (RS) Bedroom Awnings
Slide-Out Room
Slide-Out Awning
Protective Vinyl Bra Cover
Solar Panel
TV Antenna
Powder Coated Trim (Side Molding)
Powder Coated Aluminum Wheel Well Trim
Dual Fuel Fill Ports w/Locking Doors
Locking Exterior Storage Compartments
Exterior Storage Doors w/Panagraph Hinges
2 Full Width Compartment Slide-Out Trays
Luggage Compartment Lights
Exterior Convenience Light at Dump Valves
Water Pump Switch at Service Compartment
Exterior Wash Down Kit
Paper Towel/Soap Dispenser Caddy
25' Fresh Water Hose
Dual Holding Tank San-T-Flush System
Dual Water Pumps/Whisper
50' Air Service Line
30' Power Cord
Holding Tanks w/Low Point Drain Valves
Floor Mounted LPG Tank — 42 Gallon
Exterior Tank Monitor

Dimensions and Capacities

UNIT DIMENSIONS

Overall Length (Note #1)	45' 0"
Overall Height w/AC	12' 1"
Overall Width (Max.)	101-1/2"
Interior Height (Max.)	81"
Interior Width (Max.)	96"
Wheelbase*	304-1/2"

*Center of front axle to the middle of the rear axles.

WEIGHTS

Spartan® Chassis GVWR Rating	(Note #3)
Front GAWR (Lbs.)	13,200
Rear GAWR (Lbs.)	30,000
Total (Lbs.)	43,200
UWV (Note #4) (Lbs.)	38,000
GCWR (Note #5) (Lbs.)	53,200

TANK & LIQUID CAPACITIES

Fresh Water (Gal.)	160
Grey Water Holding (Gal.)	99
Body Waste Holding (Gal.)	64
Appliance LPG Tank/WC (Note #2) (Gal.)	50.4 (80% + 40.3)
Fuel Tank (Gal.)	150
Fuel Weight (Lbs.)	1050

CHASSIS

Frame	Spartan® K2 Stacked Rail
Engine	Cummins® M11 Select Plus Electronic Engine 450 HP
Torque	1450 @ 1200 RPM
Cubic Inch	661
Transmission	Allison® HD 4060, 6-Speed World w/Electronic Shifter
Alternator Amps	200 Amp Leece Neville
Tires	Goodyear® G159 11R x 22.5"

Note #1: Overall lengths taken from front bumper to rear bumper.

Note #2: Capacities shown are tank manufacturer's listed Water Capacity (W.C.). Actual filled L.P. Capacity is 80% of listing due to safety shut-off required on tank.

Note #3: Gross Vehicle Weight Rating (GVWR): Means the maximum permissible loaded weight of the motorhome.

Note #4: Unloaded Vehicle Weight (UWV): Means the weight of a vehicle, without options, with maximum capacity of all fluids necessary for operation of the vehicle, but without cargo, occupants or accessories that are ordinarily removed from the vehicle when it is not in use. Weight varies significantly based on options.

Note #5: Gross Combined Weight Rating (GCWR): Means the combined weight of the fully equipped motorhome including passengers, all cargo, fluids, etc., plus the weight of the fully loaded towed vehicle.

OPTIONS

(3) Low Profile 13,500 BTU Roof A/C
Ducting, Front to Back
Onan® Quiet Diesel Generator — 10.0 kw
w/Power Slide-Out
Aqua Hot™ Hydronic Furnace — 50,000 BTU
(3 Heat Zones, Basement Heat, Hot Water,
Defrost, Engine Pre-Heat)
LP/110V Norcold® Large Four-Door Refrigerator/
Freezer w/Ice Maker
2-Burner KitchenAid® Recessed Cook Top
w/Corian® Cover
Sharp® Carousel Convection Microwave Oven
Light/Power Range Hood
Water Filter
12V Halogen Task Lighting
110V/12V AC/DC Central Electrical Panel
50 Amp Service 120 Volt Power Center
♥ **heart interface** — Source Manager 25, 2500 Watt
Continuous Inverter, 130 Amp
Converter, Intelligent Transfer Switching
Home Entertainment System
Sony® 27" Stereo Color TV (Living Area) w/Remote
Sony® 4-Head Hi-Fi Stereo VCR w/Remote
Sony® 5-Disc Stereo CD Changer w/Remote
Sony® AM/FM Stereo/Cassette Player
10 Speakers
Sony® 20" Stereo Color TV (Bedroom) w/Remote
Park Telephone Ready
Patio Receptacles
C.B. Radio Ready
TV Cable Ready
Multi-Plex 12 Volt Switching
Link 1000 Battery Monitor
Rain Sensor Power Roof Vents w/3-Speed Fans
Smoke Detector
LPG Leak Detector
Carbon Monoxide Detector
Vacuum Cleaner — Portable

The American Heritage

gives you more ways to customize

your coach than just about any luxury vehicle on the road
today. Why, we ask, would anyone pay more for a so-called
"custom" motorcoach? The American Heritage gives you 33

different options, 12 interior decor choices, 12 exterior
graphics choices, and nearly 200 standard luxuries

to help you create the perfect coach.

General Interior

12 Custom Interior Decors
Beveled Glass Mirrors
Laminate Cabinets
Deluxe Drawer Guides w/Travel Locks
Vinyl Padded Ceiling
Cedar-Lined Wardrobe
Night Hall Lighting

Living Room

2 Villa® Leather Sleeper Sofas
w/Large Storage Drawer
6 Decor Sofa Pillows
Powered Windshield Privacy Curtain (Cockpit)
Silhouette® Blinds
Fabric Decor Wallboard Window Treatments
(Living Room, Dinette)
Deluxe Carpeting w/Thick 3/8" Padding
120 Volt Alabaster Lights
Indirect Lighting

Galley

Corian® Galley Top w/Corian® Bowl
Corian® Sink Cover
Moen® One Touch Galley Faucet
Spice Rack
Pantry
Laminate Cabinets
Corian® Countertops
Non-Skid Cabinet Shelves
Corian® Dinette Table
2 Villa® Freestanding Dinette Chairs
2 Freestanding Folding Chairs w/Covers
Napkins & Table Runner
Diagonal Porcelain Tile Flooring
Micro Mini-Blind

Bath

2 Corian® Lavy Tops w/Corian® Bowls
Brass & Chrome Bath Accessories
Deluxe Medicine Cabinet
Residential China Bowl Toilet w/Vacuum Flush
Fiberglass Shower Basin
Corian® Shower Walls w/Accent
Corian® Decor Soap Dish (Shower)
Curved Glass/Brite Brass Shower Doors
w/Magnetic Latch
Shower Seat
Diagonal Porcelain Tile Flooring
Micro Mini-Blind
Wallpaper w/Decor Border
Security Safe
Alabaster Lights
Indirect Lighting

Bedroom

Sealy® Innerspring Mattress 60" x 80"
Duvet w/Comforter w/Shams (4)
2 Bed Throw Pillows/1 Bolster
Corian® Night Stand Tops
Silhouette® Blinds
Deluxe Carpeting w/Thick 3/8" Padding
Indirect Lighting

Ladder
Lexan® Bus Armor
Polished Stainless Exterior Trim
Automatic Power Cord Reel
Additional Fresh Water Capacity
Exterior Entertainment Center
Sony® 27" Color TV w/Remote
AM/FM Stereo/Cassette Player
w/Two Speakers
Phone Jack
GPS Navigation System
Datron® Mobile DSS System
Vented Washer/Dryer
Norcold® Exterior Freezer AC/DC
Electric Rotisserie Grill (Exterior)
3-Burner Range w/Oven
Double Corian® Sink w/Cook Top
Double Corian® Sink w/Oven
Facing Dinette w/Corian® Table
Interior Rollout Storage Baskets
Slide-Out Overhead Cabinet
Desk w/Villa® Leather Recliner
2/3 Villa® Leather J-Sleeper Sofa
Villa® Leather Dinette Ensemble
California King Bed
King Bed w/Wardrobe/Pocket Door
Bunk Beds
Bunk Beds w/Wardrobe
Rotary Wardrobe
Bench Seat (Bedroom)
Large Wardrobe w/Stacked Drawers
Extended Bifold Wardrobe
Wardrobe w/Bedroom Pocket Door
Double Shirt Wardrobe w/Drawers
Heated Tile Floor